

A5

Anschweissenden DIN 3239
welded connection DIN 3239

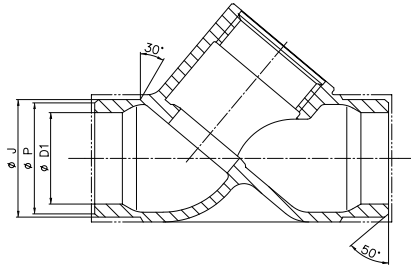

DIN 3239					
DN	G	$\varnothing J$	D1	P	Wanddicke wall thickness
15	1/2	24	17	22	3,5mm
20	3/4	30	22	28	4,0mm
25	1	36	28	34	4,0mm
32	5/4	45	35	42	5,0mm
40	6/4	52	43	49	4,5mm

A5

Anschweissenden DIN11850 R2
welded connection DIN 11850-R2

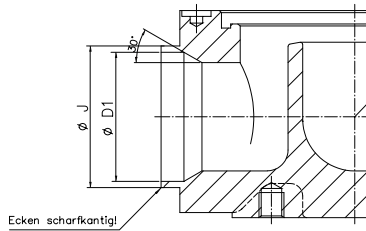

DIN 11850-Reihe2 = A5				
DN	G	$\varnothing J$	D1	Wanddicke wall thickness
15	1/2	19	16	1,5mm
20	3/4	23	20	1,5mm
25	1	29	26*	1,5mm
32	5/4	35	32	1,5mm
40	6/4	41	38	1,5mm

* nicht für BR40, 43, 49, da Rohteil $DN_{\text{innen}} 26\text{mm}$

* not for type 40, 43, 49, unfinished part $DN_{\text{internal}} 26\text{mm}$

A9

Anschweissenden ISO 4200
welded connection ISO 4200

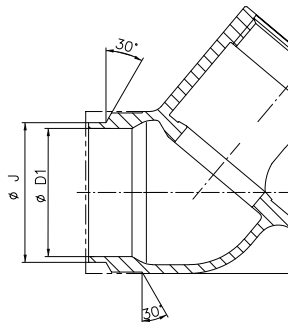

ISO 4200 = A9				
DN	G	$\varnothing J$	D1	Wanddicke wall thickness
15	1/2	21,3	18,1	1,6mm
20	3/4	26,9	23,7	1,6mm
25	1	33,7	29,7	2,0mm
32	5/4	42,4	38,4	2,0mm
40	6/4	48,3	44,3	2,0mm